

Customer name:

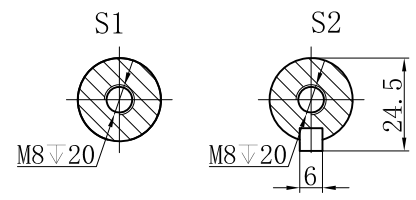
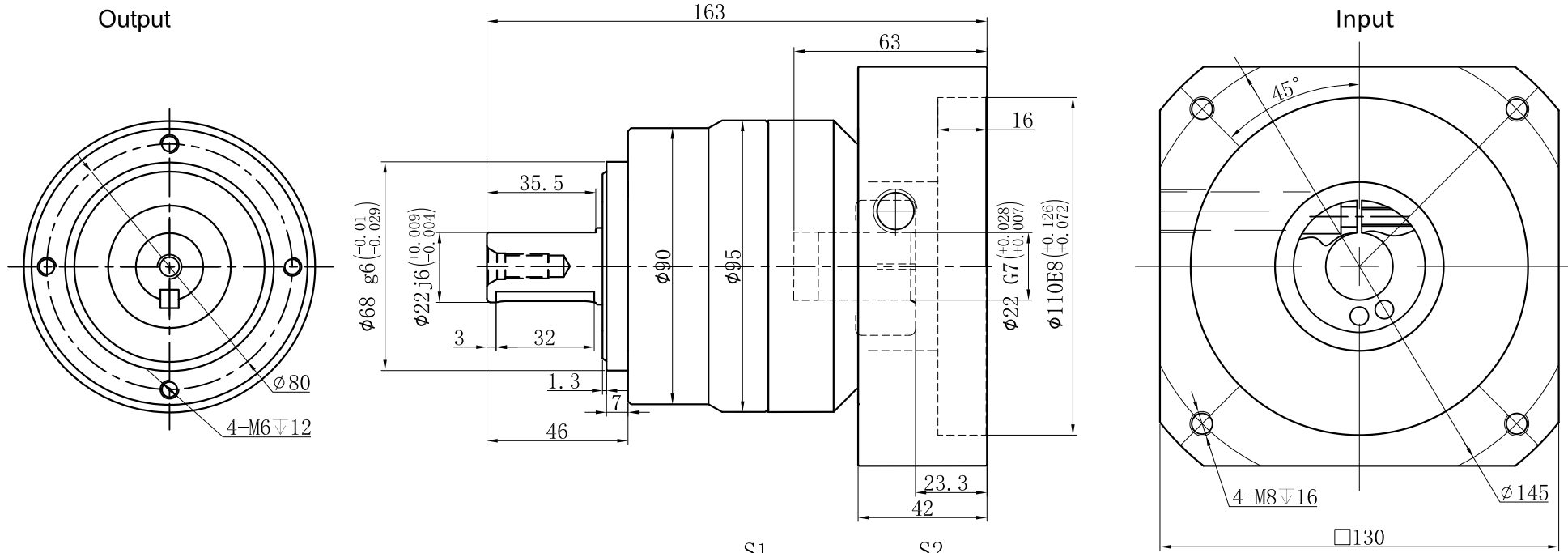

Transmission ratio	( <u>A</u> ):1	Mass moments of inertia	( <u>B</u> )Kg.cm <sup>2</sup>
Rated output torque	( <u>C</u> )Nm	Max.output torque	( <u>D</u> )Nm
Rated input speed	3000rpm	Max input speed	5000rpm
Max.radial force	3250N	Max.axial force	1625N
Efficiency	≥ 97%	Operating temperature	-20°~+90°
Mounting position	Any	Lubrication method	Synthetic grease
Weight ±3%	3.6Kg	Service life	20000h
Standard backlash	≤ 5 arcmin	Protection class	IP65
Motor power		Noise level	60dB
Motor dimensions			

	10	0.44	100	180	Sign/Date		8	0.44	120	215
	7	0.45	135	240			6	0.45	140	250
	5	0.47	150	270			3	0.61	100	180
	4	0.48	110	195						
Ratio	A	B	C	D		Ratio	A	B	C	D
Note						Precision planetary reducer	TCE090			
Mark	No.	Sign	Date			TCE090-L1				
	DRAW					Shaft Type	Precision			
	CHEC									
	APPR									
	RULE									

Above specifications are for standard reducer and may be subject to change without notice.